

12,500LTR FREE STANDING CARTAGE TANK

MATERIAL:
LLDPE MATERIAL DESIGNED SPECIFICALLY FOR ROTATIONAL MOULDING APPLICATIONS DELIVERING A HIGH ESCR, CHEMICAL RESISTANCE, STIFFNESS AND TOUGHNESS WHICH IS UV STABILISED TO PROVIDE PROLONGED OUTDOOR PROTECTION IN HARSH AUSTRALIAN CONDITIONS.

DIMENSIONS:
DIMENSIONS MAY VARY SLIGHTLY DUE TO THE SHRINKAGE NATURE OF POLYETHYLENE.

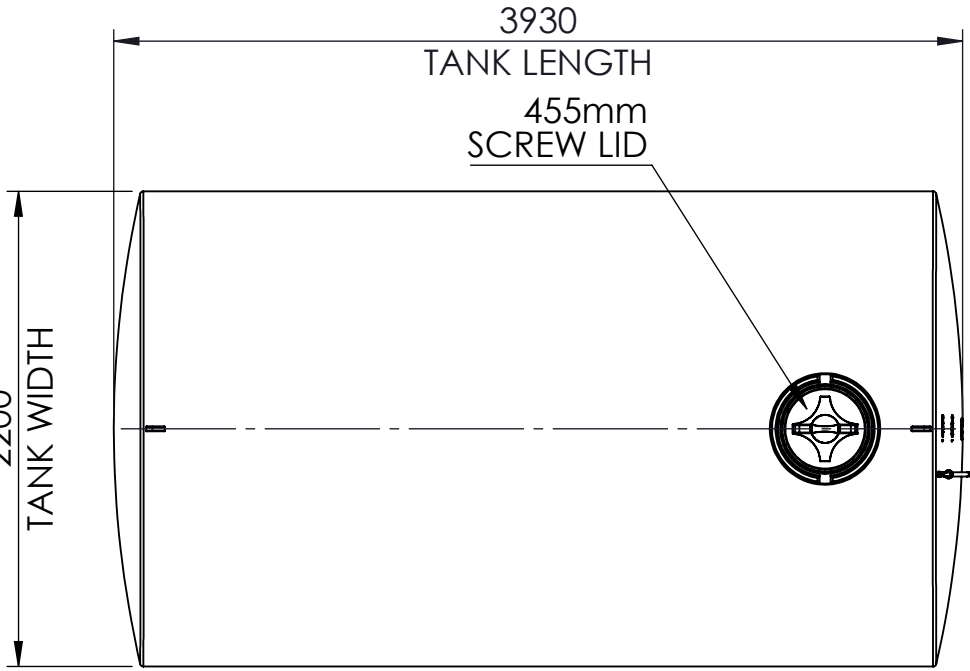
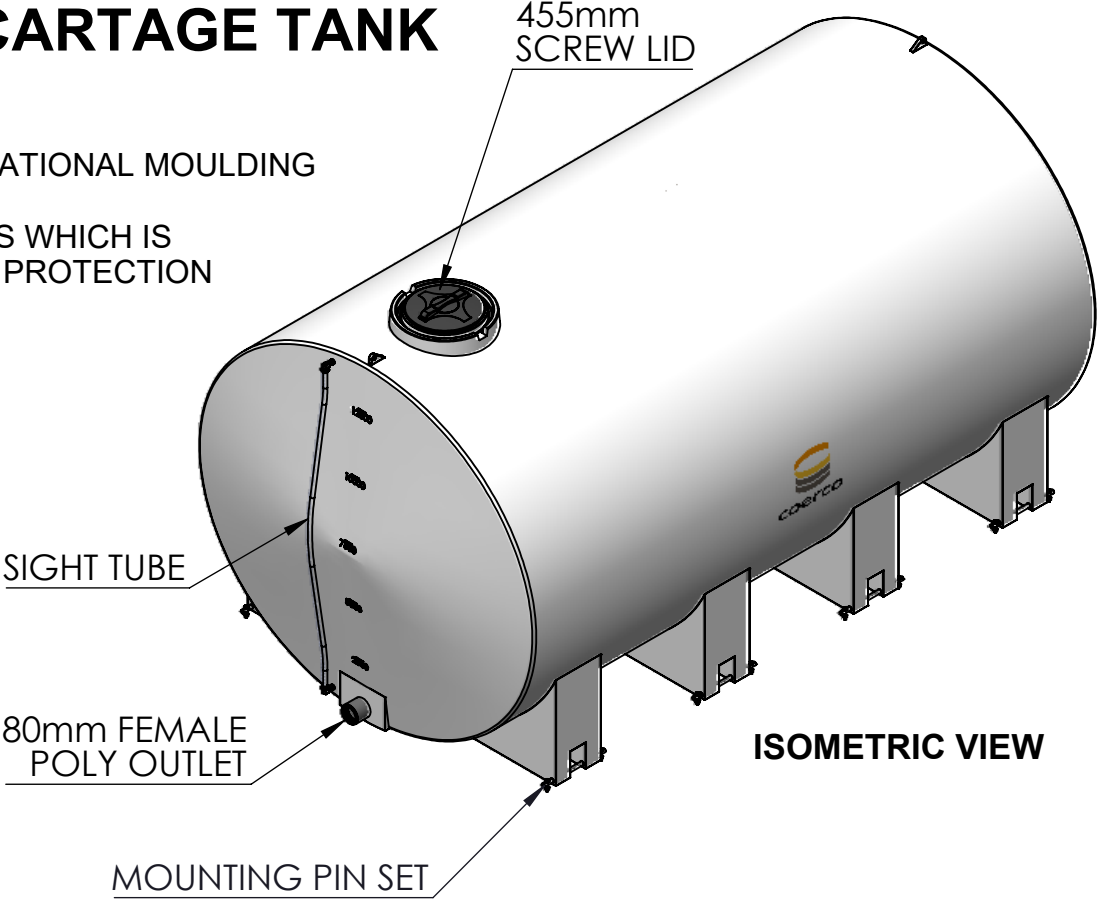

TOP VIEW

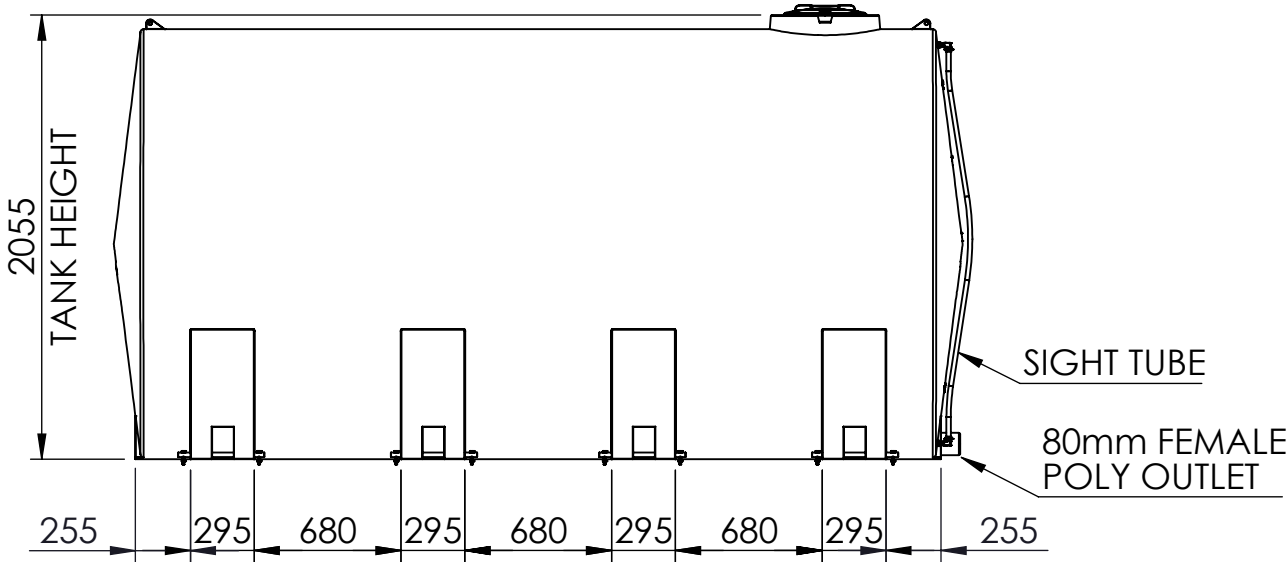

6 O'CLOCK VIEW

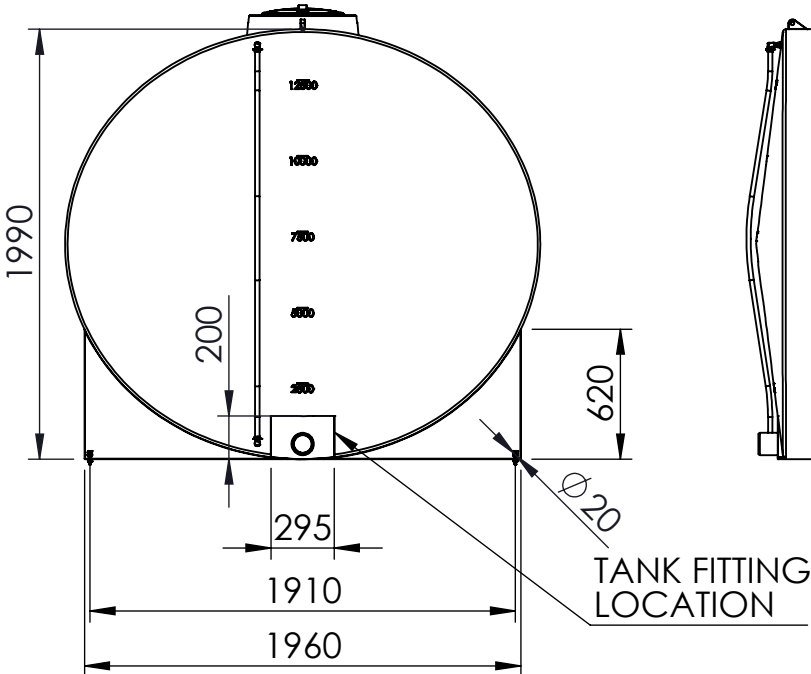

3 O'CLOCK VIEW

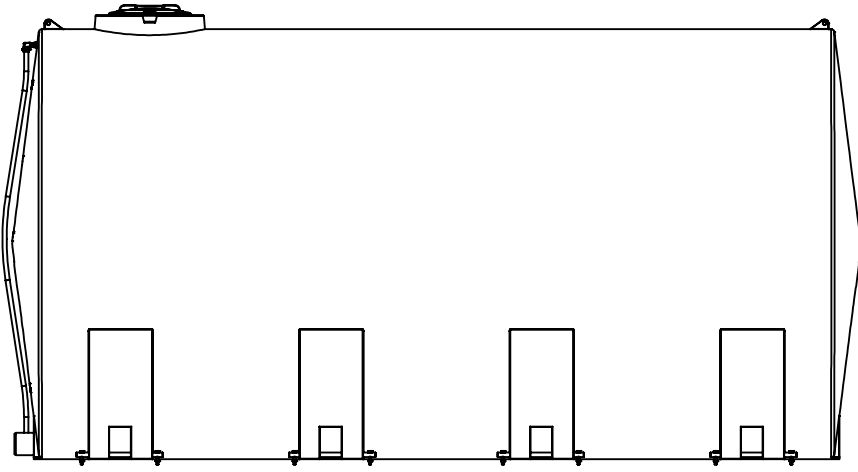

12 O'CLOCK VIEW

BARE TANK WEIGHT: 550kg

| REV | DESCRIPTION | DWN | CHK | APP | DATE |
|-----|-------------------------|-----|-----|-----|----------|
| 02 | UPDATE DRAWING TEMPLATE | KD | RB | MJ | 04.09.23 |
| 01 | ISSUED FOR CONSTRUCTION | SA | | | 01.02.22 |



| | |
|----------------|--------------------------|
| MATERIAL | LOW DENSITY POLYETHYLENE |
| COLOUR/ FINISH | |
| S.G. | |

| | |
|--------|-----|
| DWN | KD |
| CHK | RB |
| APP | MJ |
| SCALE: | NTS |

| | |
|------------|--------------------------------------|
| STOCK CODE | ST12500FS |
| PRODUCT | ST12500FS FREE STANDING CARTAGE TANK |

PROPRIETARY. Neither this document nor its contents may be used or reproduced in any manner without the written authorisation of COERCO Unless otherwise noted all dimensions are in millimetres

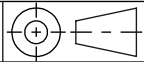

A3

COERCO
23 Harris Rd, Malaga Western Australia 6090

Phone: 1800 646 277
E-mail: info@coerco.com.au

| | | |
|--------------|--------------------------|---------|
| SHEET 1 OF 2 | DWG NO. ST12500FS_GA_001 | REV. 02 |
|--------------|--------------------------|---------|

12,500LTR FREE STANDING CARTAGE TANK
WITH SKID FRAME

MATERIAL:
LLDPE MATERIAL DESIGNED SPECIFICALLY FOR ROTATIONAL MOULDING APPLICATIONS DELIVERING A HIGH ESCR, CHEMICAL RESISTANCE,STIFFNESS AND TOUGHNESS WHICH IS UV STABILISED TO PROVIDE PROLONGED OUTDOOR PROTECTION IN HARSH AUSTRALIAN CONDITIONS.

DIMENSIONS:
DIMENSIONS MAY VARY SLIGHTLY DUE TO THE SHRINKAGE NATURE OF POLYETHYLENE.

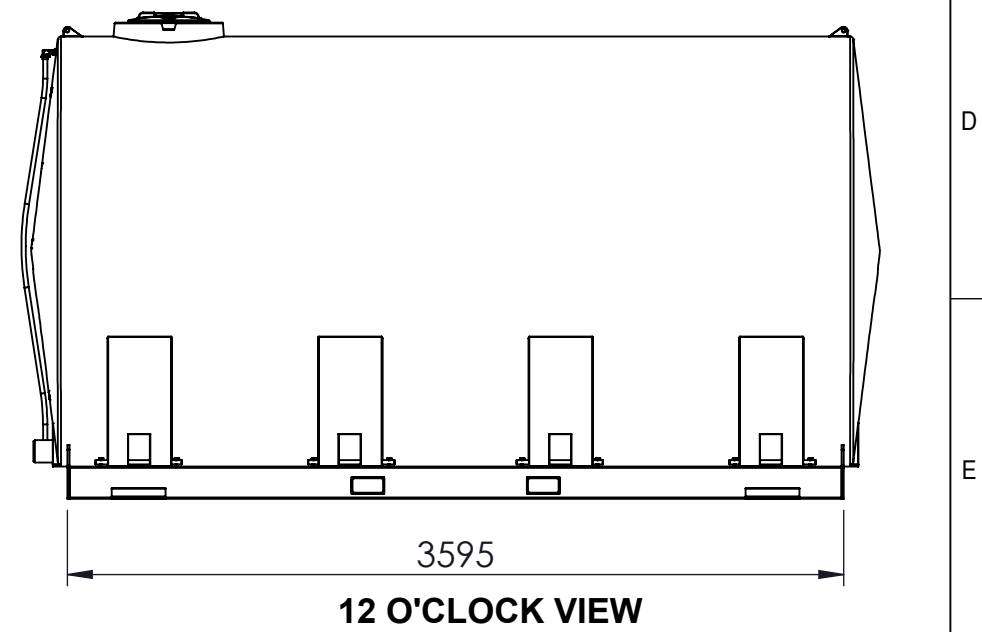
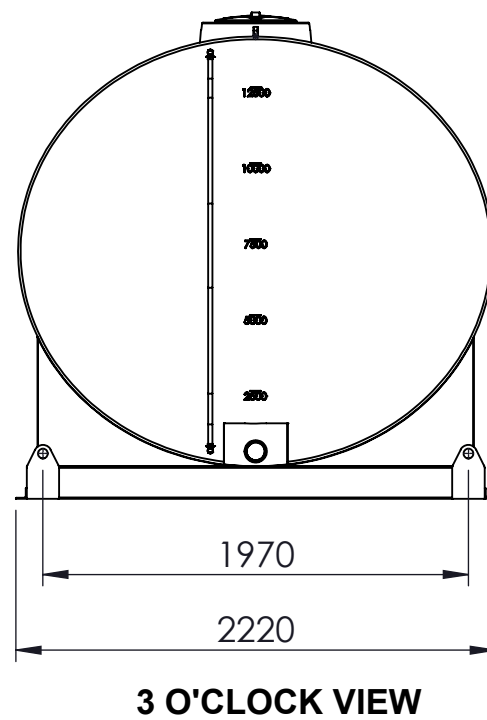
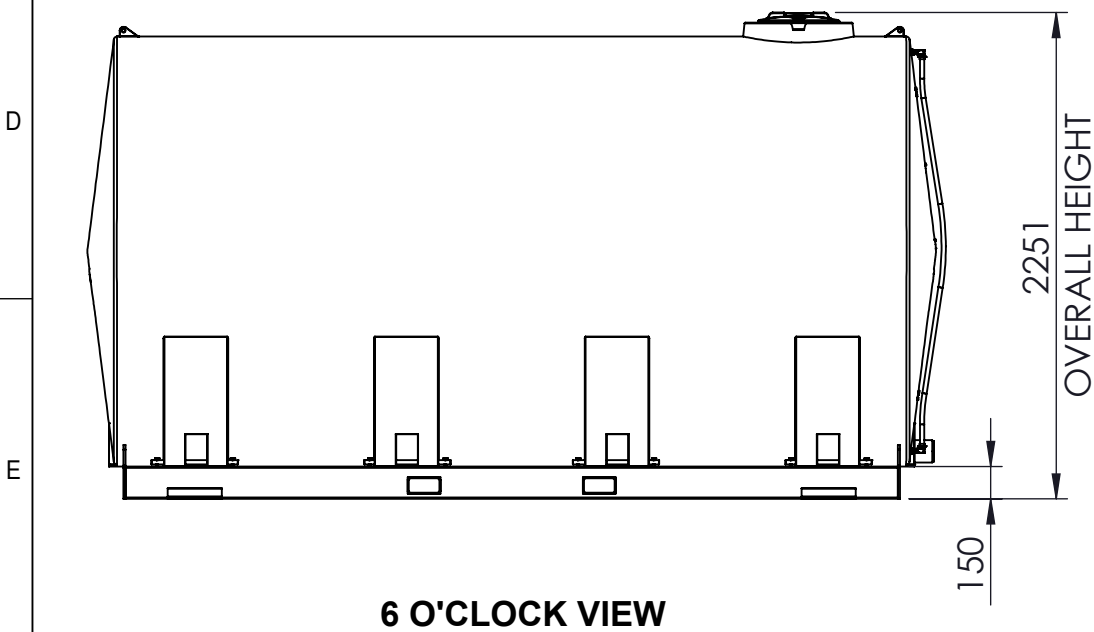
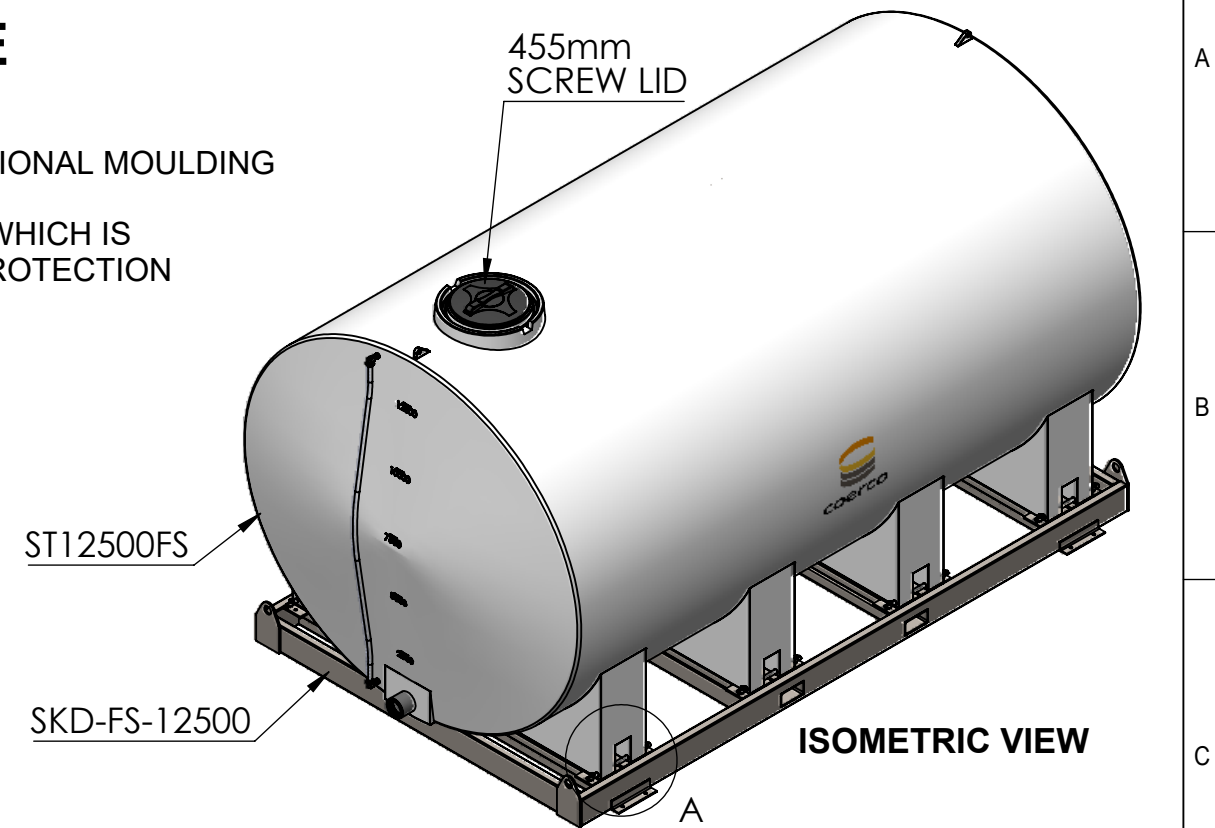
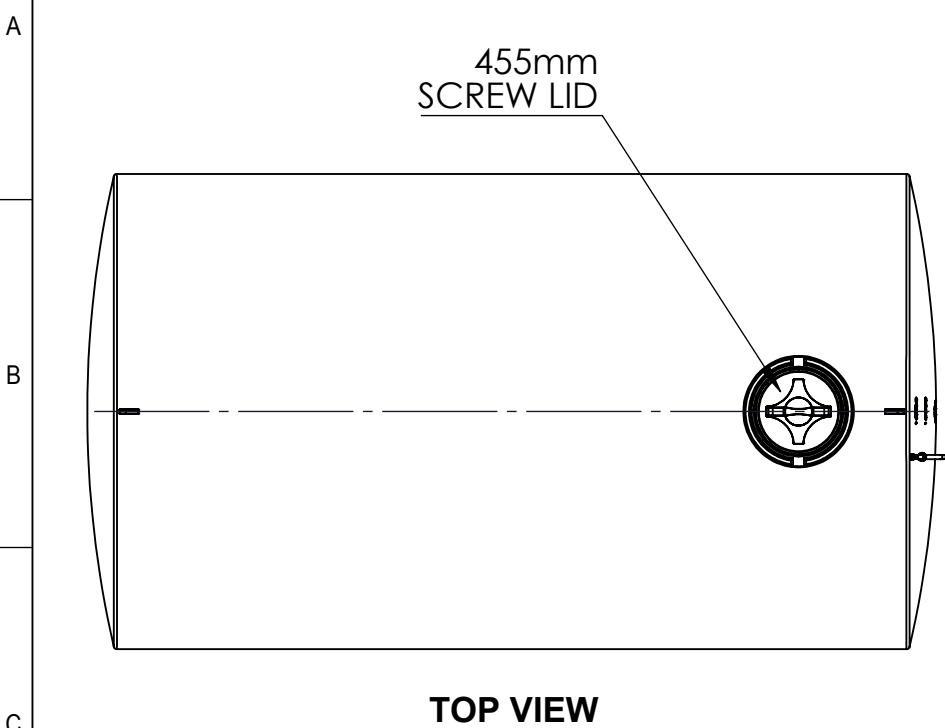
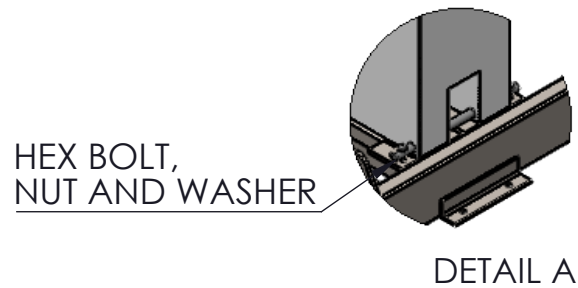

BARE TANK WEIGHT: 550kg
SKID WEIGHT: 431kg

| | | | | | |
|-----|-------------------------|-----|-----|-----|----------|
| 00 | ISSUED FOR CONSTRUCTION | KD | RB | MJ | 04.09.23 |
| REV | DESCRIPTION | DWN | CHK | APP | DATE |



| | |
|-------------------|----------------|
| MATERIAL | ASTM A36 STEEL |
| COLOUR/ FINISH | GALV |
| S.G. | |

| | |
|--------|-----|
| DWN | KD |
| CHK | RB |
| APP | MJ |
| SCALE: | NTS |

| |
|---------------------------------------|
| STOCK CODE ST12500FS AND SKD-FS-12500 |
| PRODUCT 12500 LTR FS CARTAGE TANK |
| ON SKID |

PROPRIETARY. Neither this document nor its contents may be used or reproduced in any manner without the written authorisation of COERCO Unless otherwise noted all dimensions are in millimetres

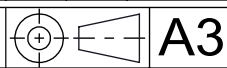

COERCO
23 Harris Rd, Malaga Western Australia 6090

Phone: 1800 646 277
E-mail: info@coerco.com.au

| | | |
|--------------|--------------------------|---------|
| SHEET 2 OF 2 | DWG NO. ST12500FS_GA_001 | REV. 00 |
|--------------|--------------------------|---------|